

Bauman Manufacturing Limited

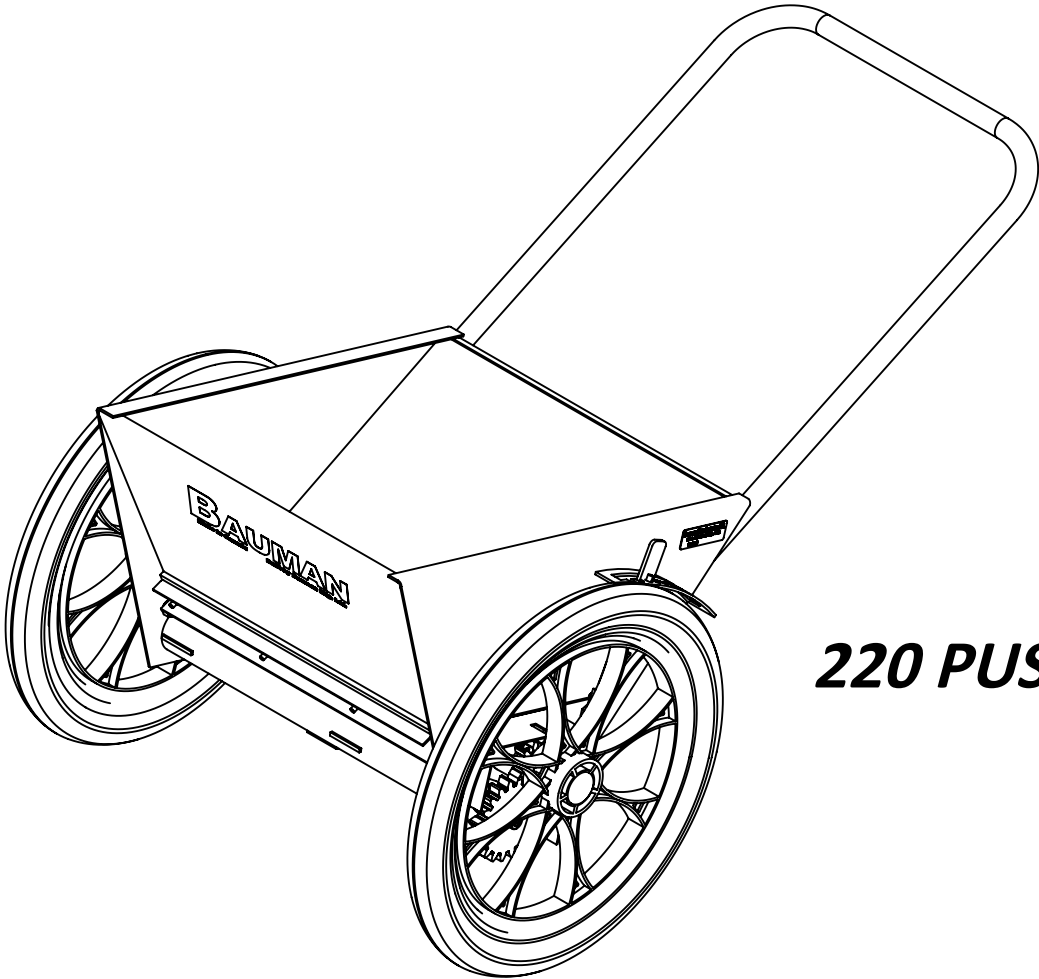

220 PUSH

Operators Manual



Sold By:



Introduction

Congratulations on your purchase of a Bauman Sidewalk Sander. This sander has been designed and manufactured to enable operators to carry out their work safely and efficiently.

The Bauman Sidewalk Sander has been designed for spreading sand, salt, grit or similar material and should only be used for this purpose. Correct usage of the machine also includes observance of the factory's preparation, operation and maintenance instructions.

This manual will help you understand the proper maintenance and operation of the sander in order to maximize the longevity and effectiveness of the machine. All information, illustrations, and technical specifications in this manual are based on the most recent product information available at the time of printing.

Bauman Manufacturing Limited reserves the right to change design and specifications and / or to make additions and improvements to the product without notice.

Please record your serial number here:



Bauman Manufacturing Limited
3 Industrial Drive
Elmira, Ontario N3B 2S1
phone 519-669-4333 fax 519-669-2431
www.baumanmfg.com

General Information About The Bauman Sidewalk Sander

The operator must read and understand all of the information in this manual to ensure they service and operate the machine correctly and thus avoid unnecessary risk of accidents and breakdowns.

Adjustment

The spring bottom tension is adjusted with the handle on the left side of the machine. Correct adjustment is important as excessive tightening will cause unnecessary wearing to the rubber belt and rotating parts while too much slack will cause uneven spreading distribution.

Starting

Spreading of material starts as soon as the unit is moved forward.

Maintenance

For optimum performance and durability, we recommend frequent and thorough cleaning of the machine. Use plenty of water while cleaning the machine in order to avoid material freezing on the roller and rubber belts. Do not spray water directly into bearings or bearing houses. Bearings must be lubricated regularly. If the machine is stored for a lengthy period of time, it is recommended that it is sprayed with acid-free oil before use.

Safety

The operator of the 220 Bauman Sidewalk Sander assumes responsibility for the safety of all persons and property within their vicinity. The operator must see to it that all persons (particularly children) stay out of the path of the sander, as well as any of the moving components within the machine. The 220 sander has been designed for single-person operation, do not allow others to ride or sit on the sander at any time.



The danger and warning labels on our equipment are for the safety of the operator and bystanders. Always read and obey these labels. It is the responsibility of the operator that all guards are in place and attached properly, and that no one reaches into the hopper while the machine is in operation. Rotating shafts can cause serious injury.

220 PARTS LIST

ITEM NO.	PartNo	DESCRIPTION
1	220 301	FINGER BAR
2	220 302	DISTRIBUTOR DRUM
3	220 303	AGITATOR
4	220 GEAR-10	GEAR (10 tooth)
5	220 GEAR-20	GEAR (20 tooth)
6	220 HANDLE	HANDLE
7	220 LEVER	TENSION LEVER
8	220 SB50-20	RUBBER FLAP (finger bar)
9	220 SB60-20	RUBBER FLAP (drum)
10	220 WHEEL LEFT	WHEEL ASSEMBLY (left)
11	220 WHEEL RIGHT	WHEEL ASSEMBLY (right)
12	UFCL 204-12	BEARING
13	220 END PLATE	END PLATE
14	220 CHANNEL	HOLD DOWN CHANNEL
15	245-034	NYLON HOLE PLUG
16	03501 108	ROLL PIN

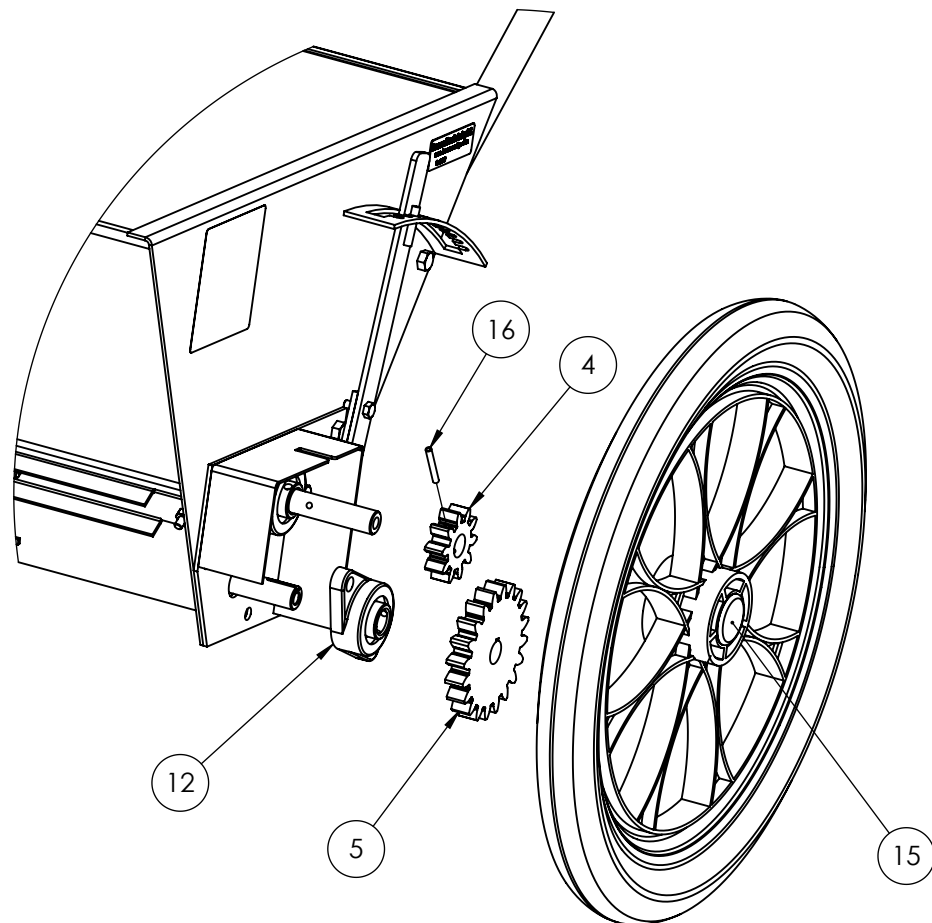
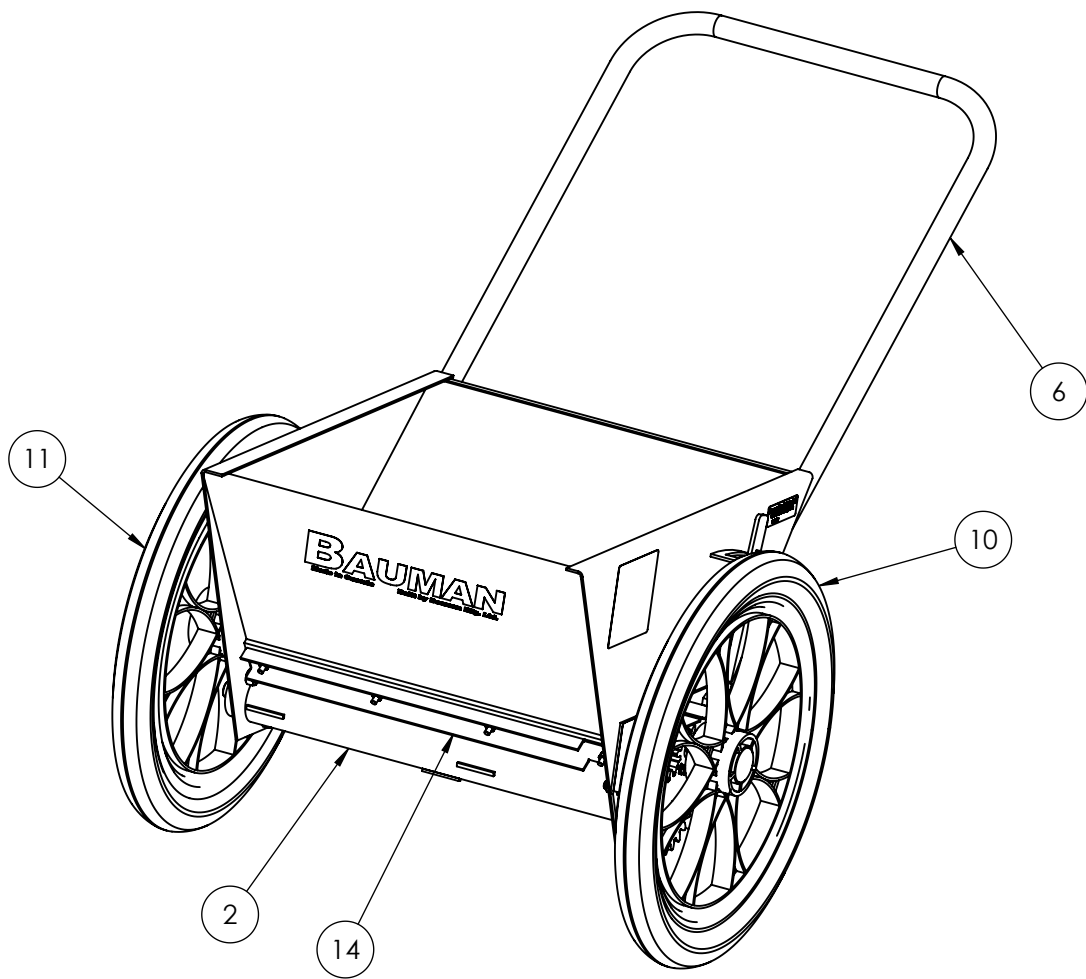

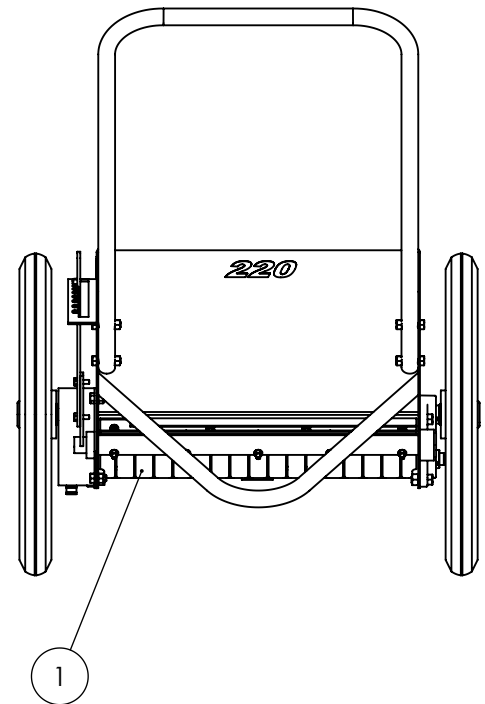
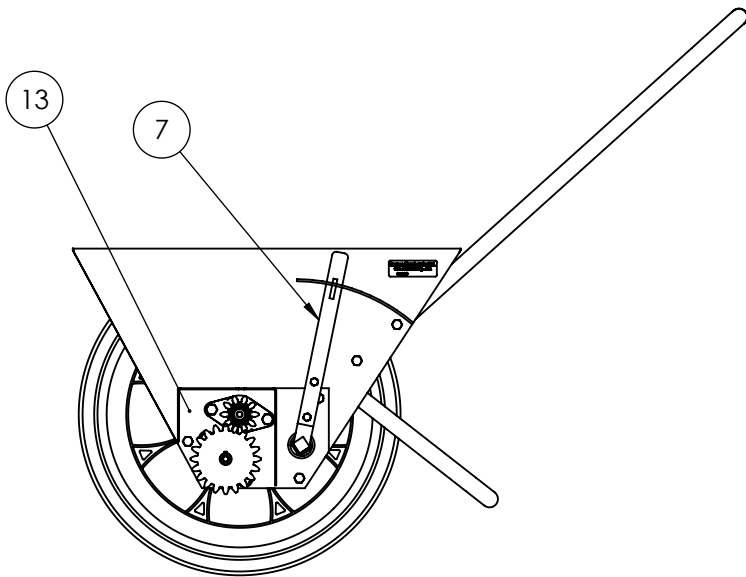
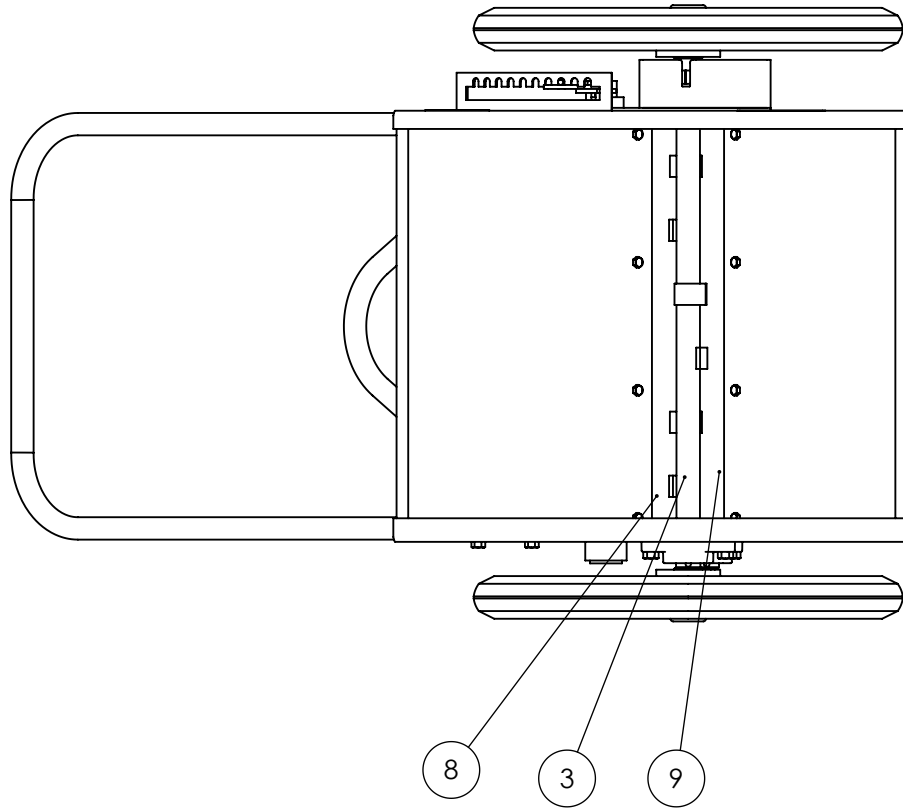



Bauman Manufacturing Limited
3 Industrial Drive
Elmira, Ontario N3B 2S1
phone 519-669-4333 fax 519-669-2431

Visit www.baumanmfg.com for more information on our Bauman Sidewalk Sanders, chains, equipment, PTOs, and more.

